



Specification for:

→ **0P49925UC**

110 Delta Drive
 Pittsburgh, PA 15238
 Phone: 412/696-1333
 Fax: 412/696-0333
 Email: magnetics@spang.com

DIMENSIONS

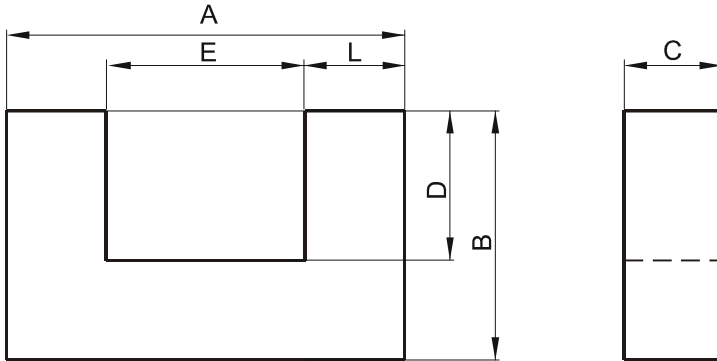

(mm)	Nominal:	Tol. min.:	Tol. max.:
A	101.6	-1.5	+ 1.5
B	57.1	-0.4	+ 0.4
C	25.4	-0.6	+ 0.6
D	31.7	-0.75	+ 0.75
E	50.8	-1.0	+ 1.0
L	25.4	-0.8	+ 0.8
Eff. Parameters			
Ae mm²	Amin mm²	le mm	Ve mm³
645.0	645.0	308.0	199000

INDUCTANCE

AL value (nH/T ²)	Test conditions
Nom: 5500±25% :	10 kHz, < 0.5 mT, 25 °C

MARKING

0P49925UC
 PXXXXX

CORE LOSSES

P _i max	Test conditions
< 32 W/set (< 161 mW/cm ³)	100 kHz, 100 mT, 100 °C

NOTE

Spec. modifications	Previous	Revised
2005-11-21	B=56.8 Min. D=31.1 Min. Losses: General P material	B=56.7 Min. D=30.95 Min. Losses: Detail as indicated
2010-09-27	Al.4920 Nom Al.3650 Min.	Al.5500±25%