

# CLASS C

# CANADIAN FUSES



## CLASS C FUSES

Ferraz Shawmut Class C fuses have British standard (BS88) dimensions and are exact replacements for the British fuses and older HRCII-C fuses. Class C fuses are not dimensionally or electrically interchangeable with other North American fuses. They feature ceramic bodies and bolt-in mounting. They are for short-circuit protection only, in motor controllers, for example, where overload protection is provided by an overload relay.

\* Ceramic version available upon request

### Ratings

- **AC:** 2 to 600A  
600VAC, 200kA I.R.
- **DC:** 460V DC, 40kA I.R.  
FES (2-60),  
FESF (250-400),  
FESC (250-400),  
450V DC, 40kA I.R.  
FESC (450-600)  
350V DC, 40kA I.R.  
FES (80-100),  
FESC (80-200)

### Approvals

- CSA Certified  
HRCII-MISC  
IEC269-2-1



### HIGHLIGHTS:

- BS88 Dimensions
- Fast-Acting

### APPLICATIONS:

- Short circuit and back-up protection of motor controllers and components

### Class C Fuse Ampere Ratings, Catalog Numbers

| AMPERE RATING | CATALOG NUMBER | AMPERE RATING | CATALOG NUMBER | AMPERE RATING | CATALOG NUMBER |
|---------------|----------------|---------------|----------------|---------------|----------------|
| 2             | FES2           | 80            | FES80          | 250           | FESF250        |
| 4             | FES4           | 100           | FES100         | 300           | FESF300        |
| 6             | FES6           | 125           | FES125         | 350           | FESF350        |
| 10            | FES10          |               | FES150         | 400           | FESF400        |
| 15            | FES15          |               | FES200         | 250           | FESC250        |
| 20            | FES20          | 80            | FESC80         | 300           | FESC300        |
| 25            | FES25          |               |                | 350           | FESC350        |
| 30            | FES30          |               |                | 400           | FESC400        |
| 40            | FES40          | 125           | FESC125        | 450           | FESC450        |
| 50            | FES50          | 150           | FESC150        | 500           | FESC500        |
| 60            | FES60          | 200           | FESC200        | 600           | FESC600        |

# CLASS C

# CANADIAN FUSES

**FES2-30**  
**FES40-60**  
**FES80-100**  
**FES125-200**

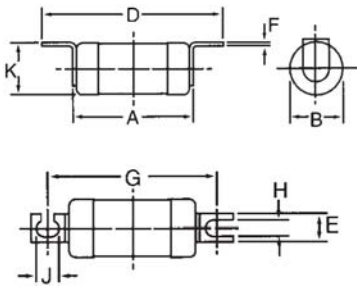

### Dimensions

**Inches**  
**(mm)**

| PART NUMBER         | A              | B              | D               | E              | F             | G               | H              | K              |
|---------------------|----------------|----------------|-----------------|----------------|---------------|-----------------|----------------|----------------|
| <b>FES 2-30</b>     | 2.06<br>(52.3) | 0.81<br>(20.6) | 3.31<br>(84.1)  | 0.35<br>(8.9)  | 0.06<br>(1.6) | 2.83<br>(71.9)  | 0.20<br>(5.2)  | 0.84<br>(21.3) |
| <b>FES 40-60</b>    | 2.19<br>(55.6) | 1.06<br>(26.9) | 3.44<br>(87.4)  | 0.50<br>(12.7) | 0.06<br>(1.6) | 2.77<br>(70.4)  | 0.20<br>(5.2)  | 1.07<br>(27.2) |
| <b>FES 80-100</b>   | 2.69<br>(68.3) | 1.34<br>(34.0) | 4.31<br>(109.5) | 0.75<br>(19.1) | 0.13<br>(3.2) | 3.64<br>(92.5)  | 0.34<br>(8.7)  | 1.43<br>(36.3) |
| <b>FES 125-200</b>  | 2.69<br>(68.3) | 1.58<br>(40.1) | 4.31<br>(109.5) | 0.75<br>(19.1) | 0.13<br>(3.2) | 3.64<br>(92.5)  | 0.34<br>(8.7)  | 1.69<br>(42.9) |
| <b>FESC 80-100</b>  | 2.44<br>(61.9) | 1.34<br>(33.9) | 5.31<br>(134.9) | 0.75<br>(19.1) | 0.13<br>(3.2) | 4.28<br>(108.7) | —              | —              |
| <b>FESC 125-200</b> | 2.44<br>(61.9) | 1.59<br>(40.3) | 5.31<br>(134.9) | 0.75<br>(19.1) | 0.13<br>(3.2) | 4.28<br>(108.7) | —              | —              |
| <b>FESF 250-400</b> | 3.00<br>(76.2) | 2.00<br>(50.8) | 5.38<br>(136.7) | 1.00<br>(25.4) | 0.25<br>(6.4) | 4.25<br>(108.0) | 0.41<br>(10.4) | —              |
| <b>FESC 250-400</b> | 3.00<br>(76.2) | 2.00<br>(50.8) | 8.25<br>(209.6) | 1.00<br>(25.4) | 0.25<br>(6.4) | 5.16<br>(131.0) | —              | —              |
| <b>FESC 450-600</b> | 3.00<br>(76.2) | 2.88<br>(73.0) | 8.25<br>(209.6) | 1.00<br>(25.4) | 0.38<br>(9.5) | 5.06<br>(128.6) | —              | —              |

### I<sup>2</sup>t Data at 200kA

| FUSE AMPERE RATING | 3-PHASE I <sup>2</sup> t Data |                           |
|--------------------|-------------------------------|---------------------------|
|                    | PRE-ARC (A <sup>2</sup> s)    | @ 600V (A <sup>2</sup> s) |
| 2                  | 2.3                           | 6.6                       |
| 4                  | 7.0                           | 20                        |
| 6                  | 22                            | 70                        |
| 10                 | 100                           | 310                       |
| 15                 | 260                           | 750                       |
| 20                 | 540                           | 1300                      |
| 25                 | 820                           | 2000                      |
| 30                 | 2800                          | 6200                      |
| 40                 | 4000                          | 10 x 10 <sup>3</sup>      |
| 50                 | 6400                          | 16 x 10 <sup>3</sup>      |
| 60                 | 12 x 10 <sup>3</sup>          | 28 x 10 <sup>3</sup>      |
| 80                 | 14 x 10 <sup>3</sup>          | 44 x 10 <sup>3</sup>      |
| 100                | 17 x 10 <sup>3</sup>          | 62 x 10 <sup>3</sup>      |
| 125                | 25 x 10 <sup>3</sup>          | 93 x 10 <sup>3</sup>      |
| 150                | 62 x 10 <sup>3</sup>          | 170 x 10 <sup>3</sup>     |
| 200                | 90 x 10 <sup>3</sup>          | 280 x 10 <sup>3</sup>     |
| 250                | 200 x 10 <sup>3</sup>         | 600 x 10 <sup>3</sup>     |
| 300                | 300 x 10 <sup>3</sup>         | 900 x 10 <sup>3</sup>     |
| 350                | 500 x 10 <sup>3</sup>         | 1600 x 10 <sup>3</sup>    |
| 400                | 630 x 10 <sup>3</sup>         | 2100 x 10 <sup>3</sup>    |
| 450                | 800 x 10 <sup>3</sup>         | 2500 x 10 <sup>3</sup>    |
| 500                | 1200 x 10 <sup>3</sup>        | 3200 x 10 <sup>3</sup>    |
| 600                | 2000 x 10 <sup>3</sup>        | 5200 x 10 <sup>3</sup>    |

**FESC80-100**  
**FESC125-200**  
**FESF250-400**

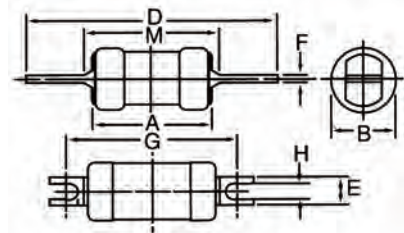

**FESC250-400**  
**FESC450-600**

