

CLASS C

CANADIAN FUSES



CLASS C FUSES

Ferraz Shawmut Class C fuses have British standard (BS88) dimensions and are exact replacements for the British fuses and older HRCII-C fuses. Class C fuses are not dimensionally or electrically interchangeable with other North American fuses. They feature ceramic bodies and bolt-in mounting. They are for short-circuit protection only, in motor controllers, for example, where overload protection is provided by an overload relay.

* Ceramic version available upon request

HIGHLIGHTS:

- BS88 Dimensions
- Fast-Acting

APPLICATIONS:

- Short circuit and back-up protection of motor controllers and components

Ratings

- **AC:** 2 to 600A
600VAC, 200kA I.R.
- **DC:** 460V DC, 40kA I.R.
FES (2-60),
FESF (250-400),
FESC (250-400),
450V DC, 40kA I.R.
FESC (450-600)
350V DC, 40kA I.R.
FES (80-100),
FESC (80-200)

Approvals

- CSA Certified
HRCII-MISC
IEC269-2-1

F

Class C Fuse Ampere Ratings, Catalog Numbers

| AMPERE RATING | CATALOG NUMBER | AMPERE RATING | CATALOG NUMBER | AMPERE RATING | CATALOG NUMBER |
|---------------|----------------|---------------|----------------|---------------|----------------|
| 2 | FES2 | 80 | FES80 | 250 | FESF250 |
| 4 | FES4 | 100 | FES100 | 300 | FESF300 |
| 6 | FES6 | 125 | FES125 | 350 | FESF350 |
| 10 | FES10 | | FES150 | 400 | FESF400 |
| 15 | FES15 | | FES200 | 250 | FESC250 |
| 20 | FES20 | 80 | FESC80 | 300 | FESC300 |
| 25 | FES25 | | FESC100 | 350 | FESC350 |
| 30 | FES30 | | | 400 | FESC400 |
| 40 | FES40 | 125 | FESC125 | 450 | FESC450 |
| 50 | FES50 | 150 | FESC150 | 500 | FESC500 |
| 60 | FES60 | 200 | FESC200 | 600 | FESC600 |

CLASS C

CANADIAN FUSES

FES2-30
FES40-60
FES80-100
FES125-200

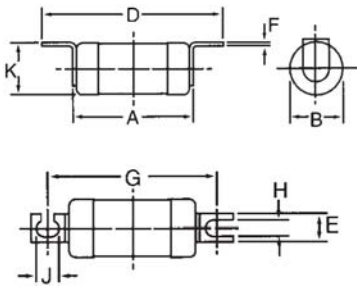

Dimensions

Inches
(mm)

| PART NUMBER | A | B | D | E | F | G | H | K |
|---------------------|----------------|----------------|-----------------|----------------|---------------|-----------------|----------------|----------------|
| FES 2-30 | 2.06 (52.3) | 0.81 (20.6) | 3.31 (84.1) | 0.35 (8.9) | 0.06 (1.6) | 2.83 (71.9) | 0.20 (5.2) | 0.84 (21.3) |
| FES 40-60 | 2.19 (55.6) | 1.06 (26.9) | 3.44 (87.4) | 0.50 (12.7) | 0.06 (1.6) | 2.77 (70.4) | 0.20 (5.2) | 1.07 (27.2) |
| FES 80-100 | 2.69 (68.3) | 1.34 (34.0) | 4.31 (109.5) | 0.75 (19.1) | 0.13 (3.2) | 3.64 (92.5) | 0.34 (8.7) | 1.43 (36.3) |
| FES 125-200 | 2.69 (68.3) | 1.58 (40.1) | 4.31 (109.5) | 0.75 (19.1) | 0.13 (3.2) | 3.64 (92.5) | 0.34 (8.7) | 1.69 (42.9) |
| FESC 80-100 | 2.44 (61.9) | 1.34 (33.9) | 5.31 (134.9) | 0.75 (19.1) | 0.13 (3.2) | 4.28 (108.7) | — | — |
| FESC 125-200 | 2.44 (61.9) | 1.59 (40.3) | 5.31 (134.9) | 0.75 (19.1) | 0.13 (3.2) | 4.28 (108.7) | — | — |
| FESF 250-400 | 3.00 (76.2) | 2.00 (50.8) | 5.38 (136.7) | 1.00 (25.4) | 0.25 (6.4) | 4.25 (108.0) | 0.41 (10.4) | — |
| FESC 250-400 | 3.00 (76.2) | 2.00 (50.8) | 8.25 (209.6) | 1.00 (25.4) | 0.25 (6.4) | 5.16 (131.0) | — | — |
| FESC 450-600 | 3.00 (76.2) | 2.88 (73.0) | 8.25 (209.6) | 1.00 (25.4) | 0.38 (9.5) | 5.06 (128.6) | — | — |

I²t Data at 200kA

| FUSE AMPERE RATING | 3-PHASE I ² t Data | |
|--------------------|-------------------------------|---------------------------|
| | PRE-ARC (A ² s) | @ 600V (A ² s) |
| 2 | 2.3 | 6.6 |
| 4 | 7.0 | 20 |
| 6 | 22 | 70 |
| 10 | 100 | 310 |
| 15 | 260 | 750 |
| 20 | 540 | 1300 |
| 25 | 820 | 2000 |
| 30 | 2800 | 6200 |
| 40 | 4000 | 10 x 10 ³ |
| 50 | 6400 | 16 x 10 ³ |
| 60 | 12 x 10 ³ | 28 x 10 ³ |
| 80 | 14 x 10 ³ | 44 x 10 ³ |
| 100 | 17 x 10 ³ | 62 x 10 ³ |
| 125 | 25 x 10 ³ | 93 x 10 ³ |
| 150 | 62 x 10 ³ | 170 x 10 ³ |
| 200 | 90 x 10 ³ | 280 x 10 ³ |
| 250 | 200 x 10 ³ | 600 x 10 ³ |
| 300 | 300 x 10 ³ | 900 x 10 ³ |
| 350 | 500 x 10 ³ | 1600 x 10 ³ |
| 400 | 630 x 10 ³ | 2100 x 10 ³ |
| 450 | 800 x 10 ³ | 2500 x 10 ³ |
| 500 | 1200 x 10 ³ | 3200 x 10 ³ |
| 600 | 2000 x 10 ³ | 5200 x 10 ³ |

FESC80-100
FESC125-200
FESF250-400

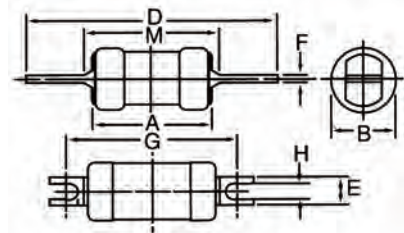

FESC250-400
FESC450-600

