

WHEN YOUR HEAVIER LOADS NEED PROTECTION A4BT FUSES WON'T LET YOU DOWN

The high interrupting rating of A4BT current limiting fuses is ideally suited for protecting mains, feeders, and general circuits. The 10-second time delay at 500% of fuse rating is ideal for large motors and other loads with a high inrush. A4BT fuses are suitable for DC applications up to 500VDC. An A4BT fuse can be applied to normal loads up to its full ampere rating to allow 100% rating of equipment.



Features/Benefits

- **Unique dimensions** prevent replacement by other fuse classes.
- **Blade-stamped catalog numbers** for permanent identification
- **Glass melamine body and plated terminals** provide superior reliability in harsh environments

HIGHLIGHTS:

- Current-Limiting
- Full 10-Second Delay
- DC Ratings
- Uniform Characteristics in all Ampere Ratings

APPLICATIONS:

- Motors
- Motor Controllers
- Transformers
- Mains
- Feeders

Ratings

- **AC:** 200 to 2,000A
600VAC, 200kA I.R.
- **DC:** 200 to 2,000A
500VDC, 100kA I.R.

Approvals

- UL Listed to Standard 248-10 (601-2000A)
- CSA Certified to Standard C22.2 No. 248.10 (601-2000A)
- DC Tested to UL 198L limits (601-2000A)



TIME DELAY / CLASS L FUSES

A4BT

Standard Fuse Ampere Ratings, Catalog Numbers

| AMPERE RATING | CATALOG NUMBER | AMPERE RATING | CATALOG NUMBER | AMPERE RATING | CATALOG NUMBER |
|---------------|----------------|---------------|----------------|---------------|----------------|
| 200 | A4BT200 | 601 | A4BT601 | 1100 | A4BT1100 |
| 250 | A4BT250 | 650 | A4BT650 | 1200 | A4BT1200 |
| 300 | A4BT300 | 700 | A4BT700 | 1400 | A4BT1400 |
| 350 | A4BT350 | 750 | A4BT750 | 1500 | A4BT1500 |
| 400 | A4BT400 | 800 | A4BT800 | 1800 | A4BT1800 |
| 500 | A4BT500 | 900 | A4BT900 | 2000 | A4BT2000 |
| 600 | A4BT600 | 1000 | A4BT1000 | | |

Three Phase Motor Fuse Selection

460 Volt Three Phase Motors

| Motor HP | Full Load Amperes at 460V | Recommended A4BT Ampere Rating | |
|----------|---------------------------|--------------------------------|---------------------------|
| | | Motor Acceleration Times | |
| | | Typical 5 seconds | Heavy Load Over 5 seconds |
| 300 | 360 | 601 | 700 |
| 400 | 477 | 800 | 1000 |
| 500 | 590 | 1000 | 1200 |

575 Volt Three Phase Motors

| | | | |
|-----|-----|-----|------|
| 400 | 382 | 601 | 700 |
| 500 | 472 | 700 | 1000 |

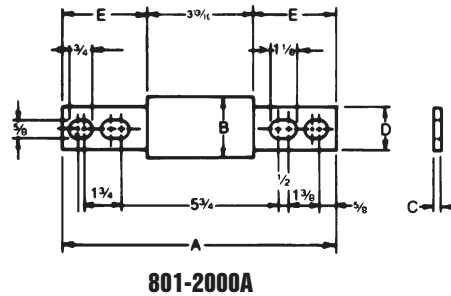
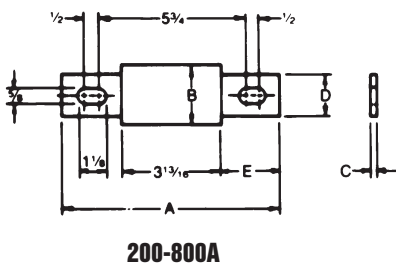

Dimensions

| AMPERE RATING | A | | B | | C | | D | | E | |
|---------------|--------|-----|-------|----|------|----|-------|----|---------|----|
| | In. | mm | In. | mm | In. | mm | In. | mm | In. | mm |
| 200-600* | 8-5/8 | 219 | 2 | 51 | 5/16 | 8 | 1-5/8 | 41 | 2-13/32 | 61 |
| 601-800 | 8-5/8 | 219 | 2-1/2 | 63 | 3/8 | 9 | 2 | 51 | 2-13/32 | 61 |
| 801-1200 | 10-3/4 | 273 | 2-1/2 | 63 | 3/8 | 9 | 2 | 51 | 3-15/32 | 88 |
| 1201-1600 | 10-3/4 | 273 | 3 | 76 | 7/16 | 11 | 2-3/8 | 60 | 3-15/32 | 88 |
| 1601-2000 | 10-3/4 | 273 | 3-1/2 | 89 | 1/2 | 13 | 2-3/4 | 70 | 3-15/32 | 88 |

Safety Note: Class L fuses are dimensioned for one-way interchangeability.
 A Class L fuse of any lower ampere rating can be substituted for a given Class L fuse.

TIME DELAY / CLASS L FUSES

A4BT

A4BT200 to 2000

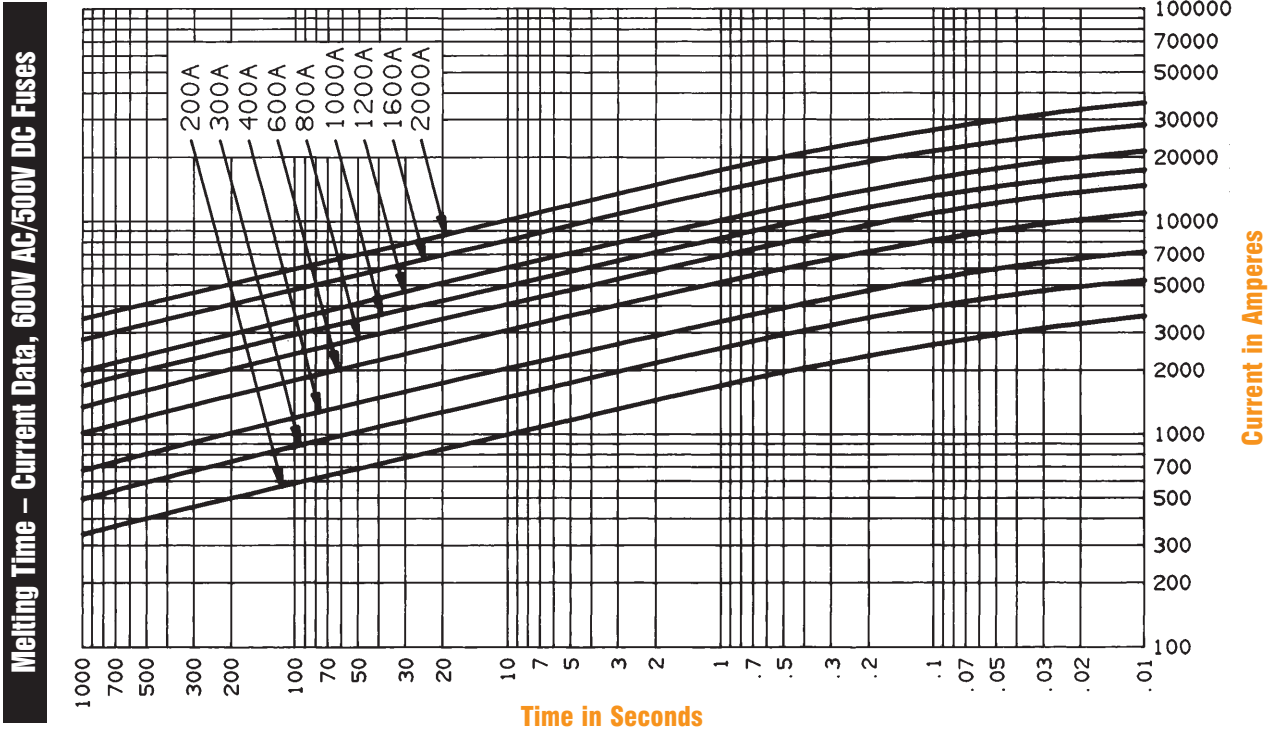

B

Peak Let-Thru Current Data – A4BT300 to 2000, 600 Volts AC

