

**WHEN YOUR HEAVIER LOADS NEED PROTECTION A4BT FUSES WON'T LET YOU DOWN**

The high interrupting rating of A4BT current limiting fuses is ideally suited for protecting mains, feeders, and general circuits. The 10-second time delay at 500% of fuse rating is ideal for large motors and other loads with a high inrush. A4BT fuses are suitable for DC applications up to 500VDC. An A4BT fuse can be applied to normal loads up to its full ampere rating to allow 100% rating of equipment.

**B**

**Features/Benefits**

- **Unique dimensions** prevent replacement by other fuse classes.
- **Blade-stamped catalog numbers** for permanent identification
- **Glass melamine body and plated terminals** provide superior reliability in harsh environments

**HIGHLIGHTS:**

- Current-Limiting
- Full 10-Second Delay
- DC Ratings
- Uniform Characteristics in all Ampere Ratings

**APPLICATIONS:**

- Motors
- Motor Controllers
- Transformers
- Mains
- Feeders

**Ratings**

- **AC:** 200 to 2,000A  
600VAC, 200kA I.R.
- **DC:** 200 to 2,000A  
500VDC, 100kA I.R.

**Approvals**

- UL Listed to Standard 248-10 (601-2000A)
- CSA Certified to Standard C22.2 No. 248.10 (601-2000A)
- DC Tested to UL 198L limits (601-2000A)



# TIME DELAY / CLASS L FUSES

# A4BT

## Standard Fuse Ampere Ratings, Catalog Numbers

| AMPERE RATING | CATALOG NUMBER | AMPERE RATING | CATALOG NUMBER | AMPERE RATING | CATALOG NUMBER |
|---------------|----------------|---------------|----------------|---------------|----------------|
| 200           | A4BT200        | 601           | A4BT601        | 1100          | A4BT1100       |
| 250           | A4BT250        | 650           | A4BT650        | 1200          | A4BT1200       |
| 300           | A4BT300        | 700           | A4BT700        | 1400          | A4BT1400       |
| 350           | A4BT350        | 750           | A4BT750        | 1500          | A4BT1500       |
| 400           | A4BT400        | 800           | A4BT800        | 1600          | A4BT1600       |
| 500           | A4BT500        | 900           | A4BT900        | 1800          | A4BT1800       |
| 600           | A4BT600        | 1000          | A4BT1000       |               | A4BT2000       |

## Three Phase Motor Fuse Selection

### 460 Volt Three Phase Motors

| Motor HP | Full Load Amperes at 460V | Recommended A4BT Ampere Rating |                           |
|----------|---------------------------|--------------------------------|---------------------------|
|          |                           | Motor Acceleration Times       |                           |
|          |                           | Typical 5 seconds              | Heavy Load Over 5 seconds |
| 300      | 360                       | 601                            | 700                       |
| 400      | 477                       | 800                            | 1000                      |
| 500      | 590                       | 1000                           | 1200                      |

### 575 Volt Three Phase Motors

|     |     |     |      |
|-----|-----|-----|------|
| 400 | 382 | 601 | 700  |
| 500 | 472 | 700 | 1000 |

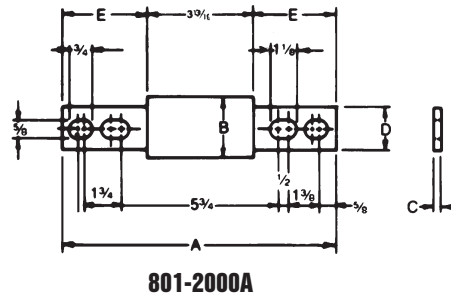
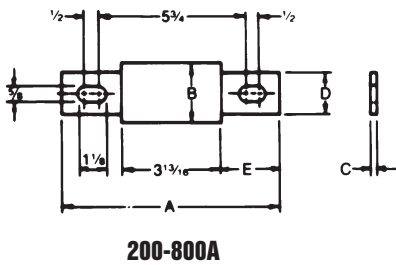

## Dimensions

| AMPERE RATING | A      |     | B     |    | C    |    | D     |    | E       |    |
|---------------|--------|-----|-------|----|------|----|-------|----|---------|----|
|               | In.    | mm  | In.   | mm | In.  | mm | In.   | mm | In.     | mm |
| 200-600*      | 8-5/8  | 219 | 2     | 51 | 5/16 | 8  | 1-5/8 | 41 | 2-13/32 | 61 |
| 601-800       | 8-5/8  | 219 | 2-1/2 | 63 | 3/8  | 9  | 2     | 51 | 2-13/32 | 61 |
| 801-1200      | 10-3/4 | 273 | 2-1/2 | 63 | 3/8  | 9  | 2     | 51 | 3-15/32 | 88 |
| 1201-1600     | 10-3/4 | 273 | 3     | 76 | 7/16 | 11 | 2-3/8 | 60 | 3-15/32 | 88 |
| 1601-2000     | 10-3/4 | 273 | 3-1/2 | 89 | 1/2  | 13 | 2-3/4 | 70 | 3-15/32 | 88 |

**Safety Note:** Class L fuses are dimensioned for one-way interchangeability.  
 A Class L fuse of any lower ampere rating can be substituted for a given Class L fuse.

# TIME DELAY / CLASS L FUSES

## A4BT

A4BT200 to 2000

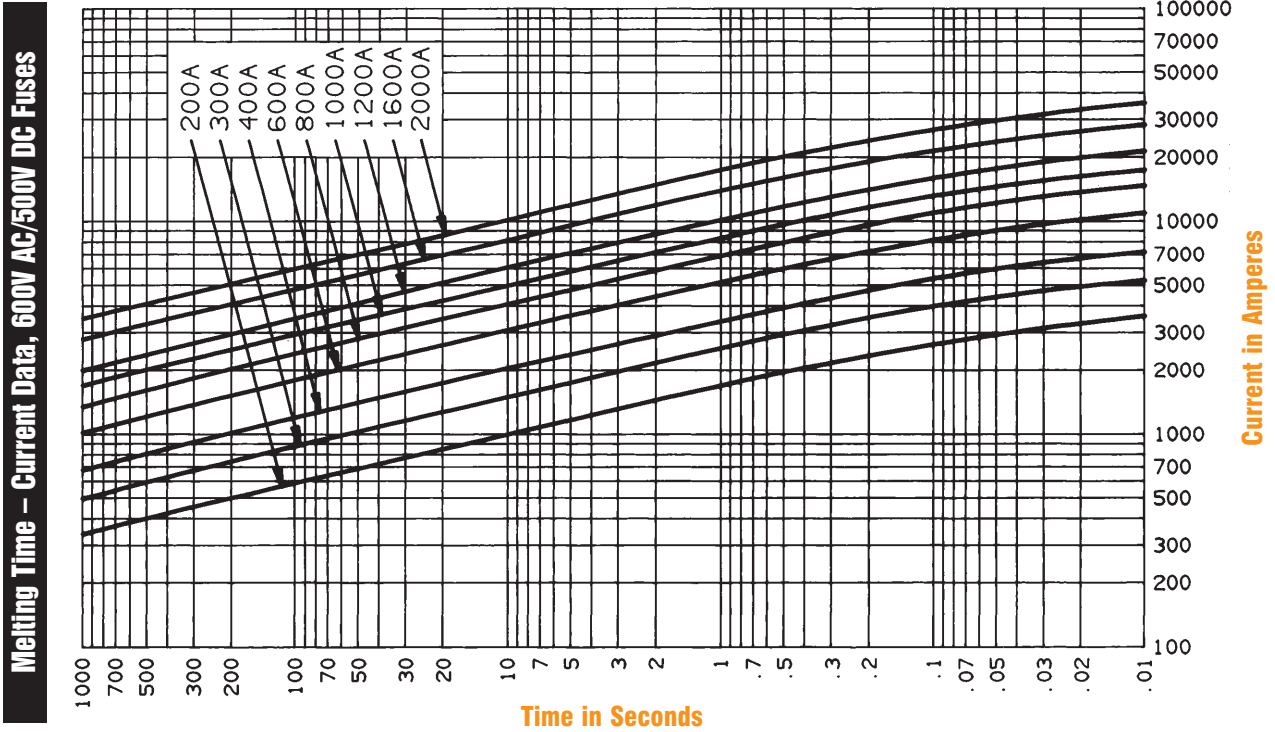

**B**

**Peak Let-Thru Current Data – A4BT300 to 2000, 600 Volts AC**

