

# CURRENT TRANSFORMERS

Model 7

Window Diameter 2.50"

APPLICATION:  
With ammeters, wattmeters, and  
cross current compensation.

FREQUENCY:  
50-400 Hz.

INSULATION LEVEL:  
600 Volts, 10 KV BIL full wave.



E93779



LR89403

- Flexible leads are UL 1015 105 ° C, CSA approved, #16 AWG, 24" long.
- Non-standard length to be specified.
- Terminals are brass studs No. 8-32 UNC with one flat washer, lockwasher and regular nut.
- SFT and SHT case styles also available as SFL and SHL with leads.
- Mounting bracket kit 0221B00182 when required for Model 7SHT.
- Approximate weight: 1.5 lb.



7SFT

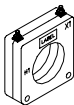
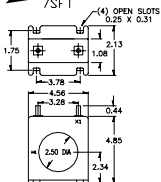

7SHT

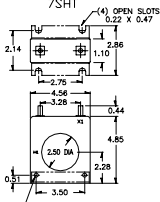

(2) 0.42 DIA HOLES



7RT

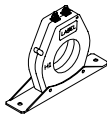
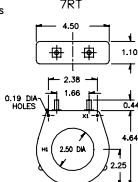

7RBT

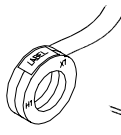
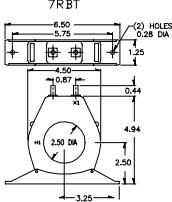

7RL

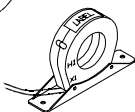

7RBL

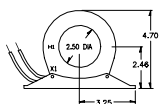
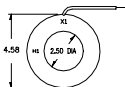
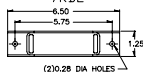

| CATALOG NUMBER | CURRENT RATIO | ACCURACY AT 60 Hz | BURDEN VA at 60 Hz |
|----------------|---------------|-------------------|--------------------|
| 7 ** - 101     | 100:5         | ± 2 %             | 2.5                |
| 7 ** - 151     | 150:5         | ± 1 %             | 5.0                |
| 7 ** - 201     | 200:5         | ± 1 %             | 5.0                |
| 7 ** - 251     | 250:5         | ± 1 %             | 5.0                |
| 7 ** - 301     | 300:5         | ± 1 %             | 12.5               |
| 7 ** - 401     | 400:5         | ± 1 %             | 15.0               |
| 7 ** - 501     | 500:5         | ± 1 %             | 25.0               |
| 7 ** - 601     | 600:5         | ± 1 %             | 30.0               |
| 7 ** - 751     | 750:5         | ± 1 %             | 30.0               |
| 7 ** - 801     | 800:5         | ± 1 %             | 35.0               |
| 7 ** - 102     | 1000:5        | ± 1 %             | 35.0               |
| 7 ** - 122     | 1200:5        | ± 1 %             | 35.0               |
| 7 ** - 152     | 1500:5        | ± 1 %             | 40.0               |
| 7 ** - 162     | 1600:5        | ± 1 %             | 45.0               |

\*\* NOTE: When ordering, prefix Cat No. with model designation required, i.e. 7SFT-500, 7RL-500, etc.