

For 1/4" × 1 1/4" Fuses



Complete part number is S-8203-1.

Series 8000

Bolt-in and Snap-in Mounting for 1/4" × 1 1/4" Fuses

Construction: Blocks are molded flame retarded thermoplastic. Clips are spring-bronze.

Voltage Rating: 300V

Agency Information:

UL Recognized ; File E14853A, Guide IZLT2

CSA Certified Class 6225-01, File 47235

Anti-Rotation Pin: Single pole blocks may be ordered without the antirotational pin simply by adding an "X" to the number of poles (Example: BK/S-8000-1X).

Carton Quantity: 10; shelf package: 100.

Bulk Carton: Single-pole and 2-pole fuse blocks—1,000; Multiple-pole fuse blocks—3-8 pole: 200; 9-12 pole: 50. When ordering bulk quantities, prefix "BK/" to catalog number: (Example: BK/S-8001-1-SNP).

Bolt-in Mounting

| Series | Terminal | Angle | Basic Cat. No. | Amperes | Poles (Suffix) |
|--------|---------------------|-------|----------------|-------------------|----------------|
| 8000 | Solder | 0° | S-8001- | UL 25A | 1 - 12 |
| | | 40° | S-8002- | CSA 21A | |
| 8100 | 3/16" Quick Connect | 0° | S-8101- | UL 20A | |
| | | 40° | S-8102- | CSA 13A | |
| 8200 | 1/4" Quick Connect | 0° | S-8201- | UL 20A | |
| | | 40° | S-8202- | CSA 16A | |
| | | Side | S-8203- | CSA 16A | |
| 8300 | Screw | — | S-8301- | UL 30A CSA 25A | |

Snap-in Mounting

| Series | Terminal | Angle | Cat. No. | Amperes | Poles (Suffix) |
|--------|---------------------|-------|--------------|---------|-------------------------------|
| 8000 | Solder | 0° | S-8001-1-SNP | UL 25A | Available only in single pole |
| | | 40° | S-8002-1-SNP | CSA 21A | |
| 8100 | 3/16" Quick Connect | 0° | S-8101-1-SNP | UL 20A | |
| | | 40° | S-8102-1-SNP | CSA 13A | |
| 8200 | 1/4" Quick Connect | 0° | S-8201-1-SNP | UL 20A | |
| | | Side | S-8203-1-SNP | CSA 16A | |

Catalog Code

| | | | | |
|-----|-----|---|----|-----|
| BK/ | S-8 | 0 | 00 | -00 |
|-----|-----|---|----|-----|

Prefix for Bulk Packing

Series 8000 Product Line

Type Terminal
 "0" - Solder
 "1" - 3/16" Quick Connect
 "2" - 1/4" Quick Connect
 "3" - Screw

Terminal Angle
 "01" - straight (0°)
 "02" - 40°
 "03" - side

Number of Poles (1-12)

*Available only in single pole



CE CE logo denotes compliance with European Union Low Voltage Directive (50-1000Vac, 75-1500Vdc). Refer to Data Sheet: 8002 or contact Bussmann Application Engineering at 636-527-1270 for more information.



4405

4406

1/4" × 1 1/4" Single Pole (6.4mm × 31.8mm)

Bakelite base; spring-bronze, bright tin-lead plate clips; 30A, 250V; base width 1/2" (12.7mm).

No. 4405—0° Solder Terminals. Integral terminal and clip.

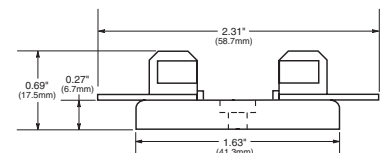

No. 4406—Side Solder Terminal
No. 4574—Spare Fuseblock

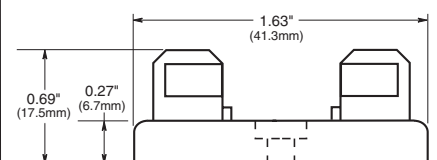

No. 2499—Side Quick-Connect Terminals. 1/4" (6.4mm); 15A, 250V. UL Recognized, Guide IZLT2, File E14853.

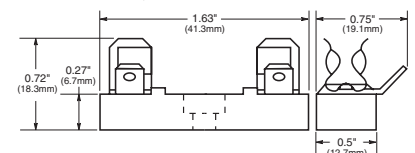

Note—Mounting screw hole diameter is 0.147" (3.7mm). Counterbore diameter, 0.636" (8.0mm). Max. Mounting Screw No. 6.



2499

4574



Data Sheet: 2101