

For 1/4" x 1 1/4" Fuses



Complete part number is S-8201-1.

Series 8000

Bolt-in and Snap-in Mounting for 1/4" x 1 1/4" Fuses

**Construction:** Blocks are molded flame retarded thermoplastic. Clips are spring-bronze.

**Voltage Rating:** 300V

**Agency Information:**

UL Recognized ; File E14853A, Guide IZLT2

CSA Certified Class 6225-01, File 47235

**Anti-Rotation Pin:** Single pole blocks may be ordered without the antirotational pin simply by adding an "X" to the number of poles (Example: BK/S-8000-1X).

**Carton Quantity:** 10; shelf package: 100.

**Bulk Carton:** Single-pole and 2-pole fuse blocks-1,000; Multiple-pole fuse blocks-3-8 pole: 200; 9-12 pole: 50. When ordering bulk quantities, prefix "BK/" to catalog number: (Example: BK/S-8001-1-SNP).

Bolt-in Mounting

Series	Terminal	Angle	Basic Cat. No.	Amperes	Poles (Suffix)
8000	Solder	0° 40°	S-8001- S-8002-	UL 25A CSA 21A	1 - 12
8100	3/16" Quick Connect	0° 40°	S-8101- S-8102-	UL 20A CSA 13A	
8200	1/4" Quick Connect	0° 40° Side	S-8201- S-8202- S-8203-	UL 20A CSA 16A	
8300	Screw	—	S-8301-	UL 30A CSA 25A	

Snap-in Mounting

Series	Terminal	Angle	Cat. No.	Amperes	Poles (Suffix)
8000	Solder	0° 40°	S-8001-1-SNP S-8002-1-SNP	UL 25A CSA 21A	Available only in single pole
8100	3/16" Quick Connect	0° 40°	S-8101-1-SNP S-8102-1-SNP	UL 20A CSA 13A	
8200	1/4" Quick Connect	0° Side	S-8201-1-SNP S-8203-1-SNP	UL 20A CSA 16A	

Catalog Code

BK/	S-8	0	00	-00
-----	-----	---	----	-----

Prefix for Bulk Packing

Series 8000 Product Line

Type Terminal  
 "0"- Solder  
 "1"- 3/16" Quick Connect  
 "2"- 1/4" Quick Connect  
 "3"- Screw

Terminal Angle  
 "01"- straight (0°)  
 "02"- 40°  
 "03"- side

Number of Poles (1-12)

\*Available only in single pole



CE CE logo denotes compliance with European Union Low Voltage Directive (50-1000Vac, 75-1500Vdc). Refer to Data Sheet: 8002 or contact Bussmann Application Engineering at 636-527-1270 for more information.



4405

4406

1/4" x 1 1/4" Single Pole (6.4mm x 31.8mm)

Bakelite base; spring-bronze, bright tin-lead plate clips; 30A, 250V; base width 1/2" (12.7mm).

**No. 4405**—0° Solder Terminals. Integral terminal and clip.

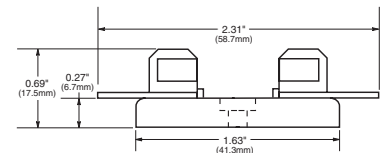

**No. 4406**—Side Solder Terminal  
**No. 4574**—Spare Fuseblock

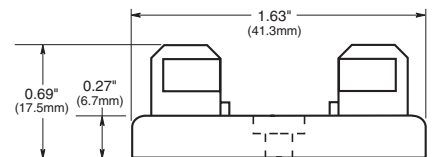

**No. 2499**—Side Quick-Connect Terminals. 1/4" (6.4mm); 15A, 250V. UL Recognized, Guide IZLT2, File E14853.

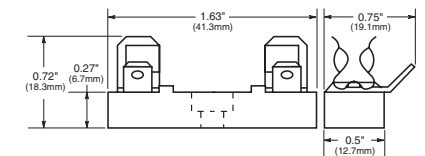

Note—Mounting screw hole diameter is 0.147" (3.7mm). Counterbore diameter, 0.636" (8.0mm). Max. Mounting Screw No. 6.



2499

4574

Data Sheet: 2101

